

# Delta 1699-09

## High Pressure Hydraulic Gun Repair Parts and Accessories

Drawing Number	Part Number	Part Description
—	1699-09	Hydraulic lubricator complete
—	1701-09	Hydraulic lubricator only
1.	1603-09	Handle
2.	1604-09	Fulcrum assembly
3.	1605-09	Linkage assembly
—	1606-09	Links (2 required)
—	1607-09	Link bolts (3 required)
—	1608-09	Link nuts (3 required)
—	1609-09	Body assembly (* these items included)
4.	1610-09	Body *
5.	1611-09	Hydraulic pump cylinder.(with piston "O" ring) *
6.	1612-09	"O" ring (piston seal)
7.	1613-09	"O" ring (top of pump cylinder) *
8.	1614-09	"O" ring (bottom of pump cylinder) *
9.	1615-09	Pump piston *
10.	1616-09	Check valve assembly *
11.	1617-09	By-pass valve with "O" ring *
12.	1618-09	"O" ring (by-pass valve)
13.	1619-09	By-pass valve stop *
14.	1620-09	By-pass valve stop screw *
15.	1621-09	Internal relief valve *
16.	1622-09	"O" ring * (internal relief valve)
17.	1623-09	Hydraulic fluid bag w/bleeder
18.	1624-09	Hydraulic fluid bag seal ring
19.	1625-09	Hydraulic fluid bag barrel
20.	1626-09	Hydraulic fluid bag barrel cap
21.	1627-09	High pressure sealant barrel
22.	1628-09	"O" ring (sealant barrel)
23.	1629-09	Sealant barrel cap
24.	1630-09	Piston assembly (** these items included)
25.	1631-09	Washer nut (2 required) **
26.	1632-09	Cut leathers (2 required) **
27.	1633-09	Piston body **
28.	1634-09	"O" ring (piston body) **
29.	1635-09	Piston cap screw **
30.	1636-09	"O" ring (piston cap screw) **
31.	1015-09	Giant buttonhead coupler with adapter
—	1014-09	Giant buttonhead coupler adapter only
—	10A5-09	Giant buttonhead coupler only
32.	1021-09	16" swivel hose only
33.	1495-09	Gauge adapter 1/4" NPT
34.	1500-09	High pressure gauge with adapter
35.	1501-09	High pressure (15,000 p.s.i.) gauge only
—	1637-09	One pint can of hydraulic fluid
—	1638-09	One gallon can of hydraulic fluid
—	1639-09	Spanner wrench for sealant pison

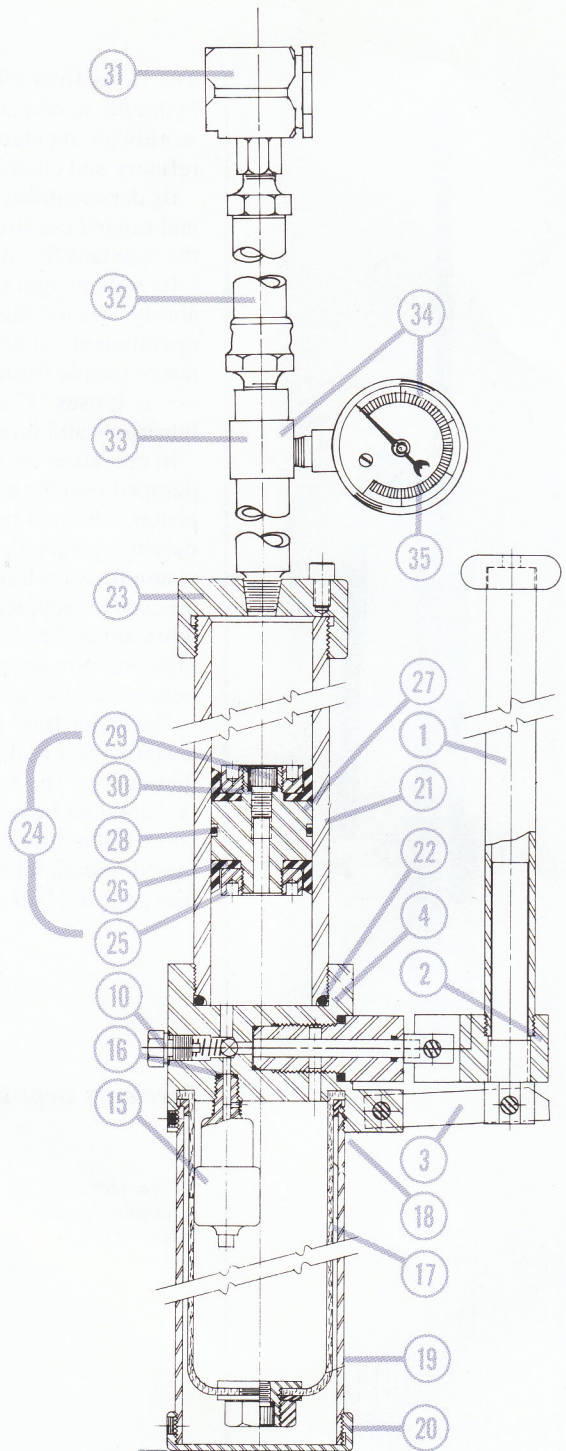

### Vent fitting lubrication adapter with buttonhead fitting

VFBJ-09 F/ 3/4-16

VFBK-09 F/ 7/8-14

VFBH-09 F/ 1-14

VFBM-09 F/ 1-14 (WKM style)

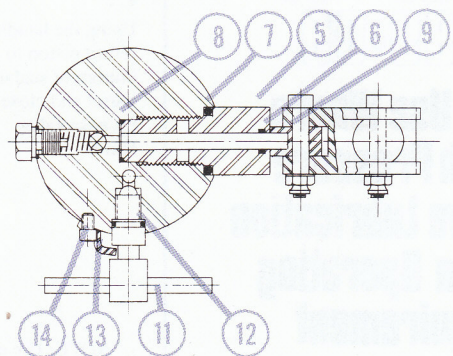
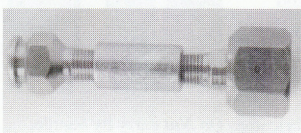

CHEMOLA™